



PEM PERIPHERAL VANE PUMP



Product Catalogue

Description

CRI Peripheral pumps are crafted with a volute chamber and impellers that aim to enhance hydraulic efficiency and suction lift capabilities. The stainless steel inserts within the pump casing reduce wear and tear, leading to a longer lifespan and preventing the pump from seizing during extended periods of inactivity. The motor stator is constructed from low watt loss steel laminations, with windings made of high-grade enameled copper wire and varnish impregnation. A dynamically balanced rotor ensures smooth, vibration-free, and noiseless operations. The motor frame's construction and the use of premium materials contribute to high performance, minimal temperature increase, and an extended motor lifespan.

Features

Sturdy and compact.

Quiet and maintenance free.

Incorporated with thermal overload protector.

Dynamically balanced rotating parts

Applications

Residential

Gardens

Pressure Boosting for Individual Houses

Specifications

Power Range :	0.37 kW & 0.75 kW
Speed :	2900 rpm
Version:	Single phase, 230V, 50Hz, A.C Supply (Permanent split capacitor-PSC)
Type of Duty :	S1 (Continuous)
Direction of Rotation :	Clockwise viewed from driving end
Degree of Protection :	IP 54
Class of Insulation :	'B'
Suction and Delivery Size in mm :	25 x 25

Materials of Construction

Pump Casing :	Cast iron
Motor Frame :	Aluminium
Impeller :	Brass
Pump Bracket :	Cast iron
Shaft :	S.S 410
Water Filling Plug :	Brass
Mechanical Seal :	Carbon & Ceramic
'O'Ring :	NBR

Pump Operating Limits

Maximum Suction Lift upto :	Up to 7m
Flow Rate upto :	2.2 m ³ /h
Maximum Head upto :	61m
Maximum Operating Pressure :	6 bar
Maximum Liquid Temperature :	33°C
Maximum Ambient Temperature :	40°C

Performance Curves

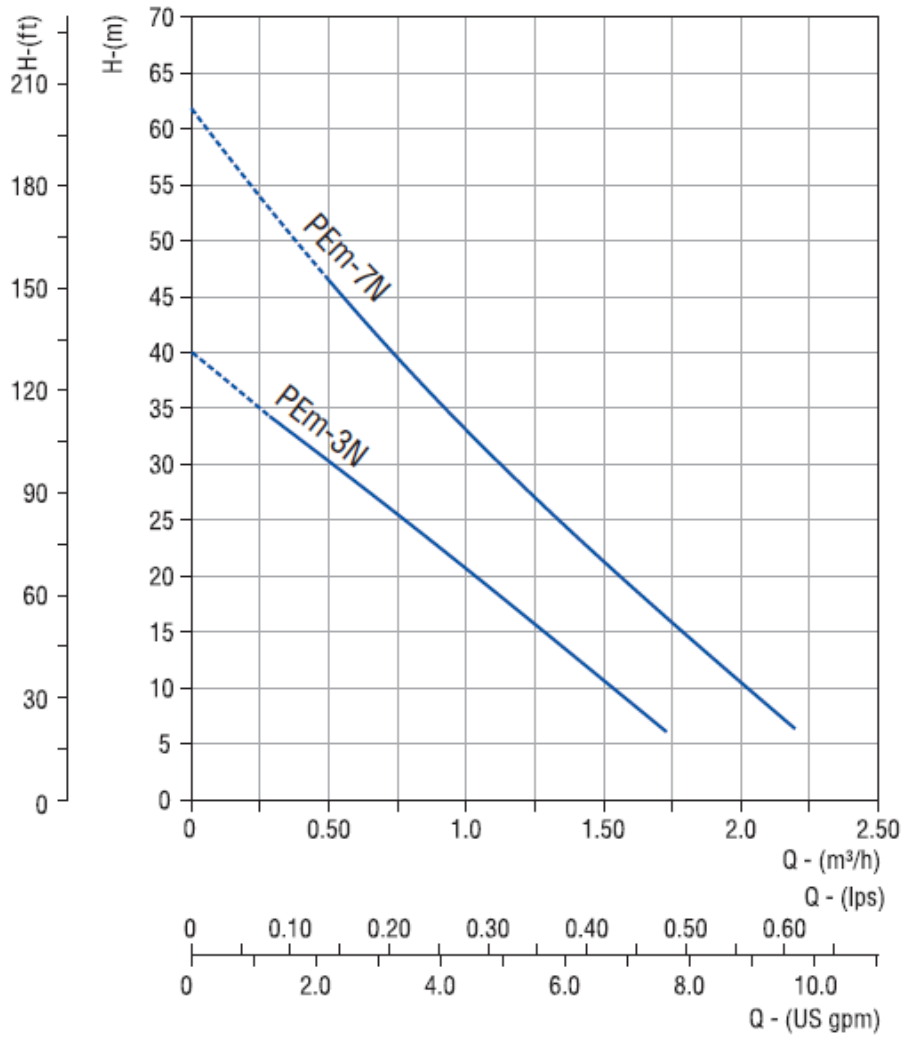

Performance Chart

PUMP MODEL	MOTOR POWER		RATED CURRENT (A) 1Ph 230V	NOMINAL PUMP SIZE IN INCHES (Suc x Del)	SUCTION LIFT IN m	DISCHARGE IN lps / m³/h							
	kW	HP				lps	0	0.1	0.2	0.3	0.4	0.5	0.6
						m³/h	0	0.4	0.7	1.1	1.4	1.8	2.2
PEm-3N	0.37	0.5	2.5	1 x 1	7	Total head in metres	40	33	27	18	12	5	
PEm-7N	0.75	1.0	5.2	1 x 1	7		61	51	41	31	23	14	6

Dimensional Drawing

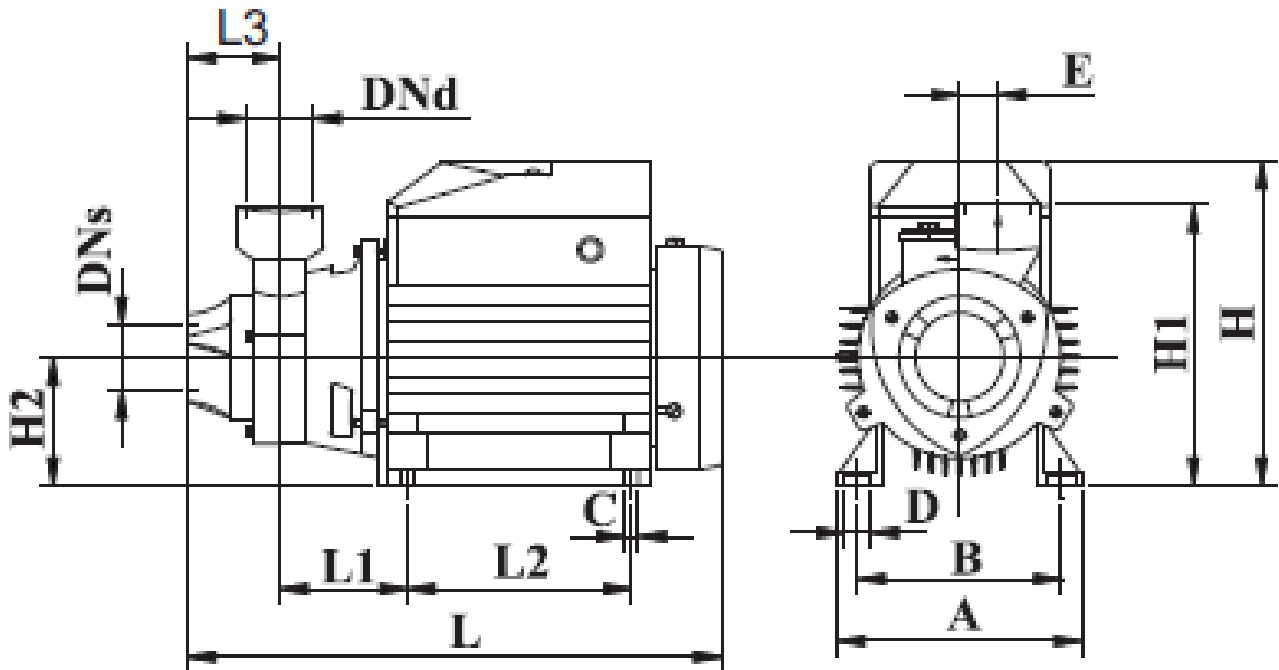

Dimensional Data

PUMP MODEL	MOTOR kW	DNs	DNd	L1	L2	L	A	B	C	D	E	H	H1	H2	L3	APPROX NETT WEIGHT kg
PEm-3N	0.37	1"	1"	61	80	265	118	100	10	10	20	151	138	63	45	5.3
PEm-7N	0.75	1"	1"	66	90	305	136	112	10	10	21	181	150	73	90	10

* All Dimensions are in mm.



+27 62 375 5088



+27 65 321 5803



<https://www.thewatersolarcompany.co.za/>



<https://maps.app.goo.gl/MBR2LMW3T6f9TtHV9>



<https://www.facebook.com/watersolarcompany>



<https://www.youtube.com/@TheWaterSolarCompany/>



<https://www.instagram.com/watersolarcompany2023/>