



CT SERIES CENTRIFUGAL PUMP

PRODUCT CATALOGUE

Centrifugal Monoblock Pumps

APPLICATIONS

Residential water supply, agricultural irrigation, industrial water usage, overall water distribution, drip and sprinkler irrigation systems, as well as water treatment facilities.

FEATURES

Increased efficiency leads to reduced power consumption. Smoothly running components are finely tuned for a quiet and vibration-free operation.

Single-phase pumps come equipped with a built-in thermal overload protector for added safety.

SPECIFICATIONS

- Power Range : 0.37kW-2.2kW
- Speed : 2900 rpm.
- Degree of Protection : IP 44 / IP 54
- Class of Insulation : B
- Versions : Single phase - 230V, 50Hz, A.C. Supply v
(Permanent split capacitor-PSC) Incorporated with Thermal Overload Protector. Three phase - 380-415V, 50Hz A.C. supply
- Type of Duty : S1 (Continuous).
- Direction of Rotation : Clockwise viewed from driving end.
- Nominal Delivery Size in mm : 25 to 80
- Nominal Suction Size in mm : 25 to 80
- Connection : Screw / Flange type (BSP)

MATERIALS OF CONSTRUCTION

- Pump Casing : Cast Iron
- Motor Frame : Aluminium / Cast Iron
- Impeller : Cast Iron / S.S / Brass / Bronze
- Shaft : S.S 410 / S.S 304 / Carbon Steel
- Sealing : Mechanical Seal (Carbon & Ceramic)

PUMP OPERATING LIMITS

- Maximum Head : 52.5m
- Maximum Suction Lift : Up to 7m
- Maximum Liquid Temperature : 33°C
- Maximum Ambient Temperature : 40°C

CTS SINGLE STAGE SERIES

Performance Curves

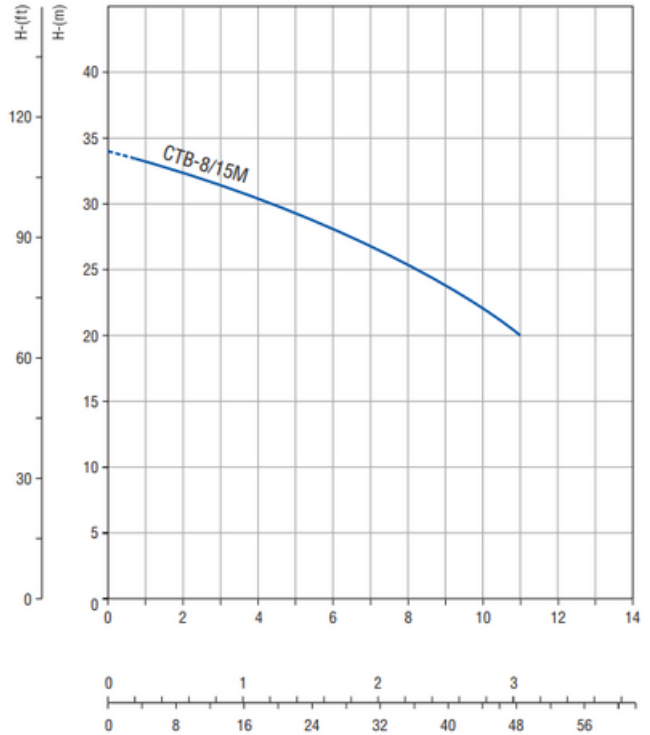
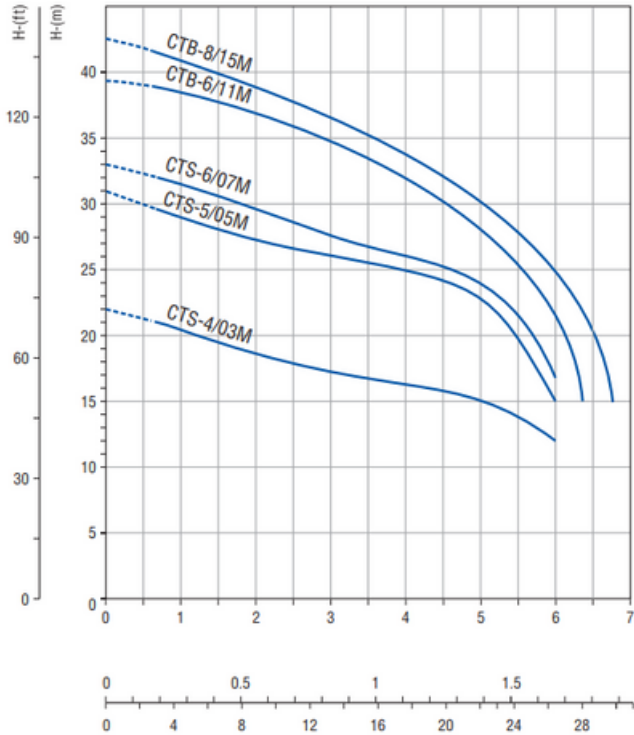

Performance Charts

PUMP MODEL	MOTOR POWER		RATED CURRENT(A)		NOMINAL PUMP SIZE in Inches (Suc x Del)	DISCHARGE IN lps / m³/h							
			1Ph 230V	3Ph 380V		0	0.3	0.6	0.8	1.1	1.4	1.7	1.9
	kW	HP	0	1		2	3	4	5	6	7		
CTS-4/03M	0.37	0.5	4.6	1.6	1 x 1	22	20.5	18.5	17	16.5	14	12	
CTS-5/05M	0.55	0.75	5.5	2	1 x 1	31	30	27	26	25	24	15	
CTS-6/07M	0.75	1.0	6.4	2.5	1 x 1	33	31.5	29.5	27.5	26	23	15	
CTB-6/11M	1.1	1.5	8.85	2.65	1 x 1	39	38	37	34.5	32	28	22	15 (6.3m³/h)
CTB-8/15M	1.5	2.0	9.38	3.51	1 x 1	43	42	38.5	37	33	30	25	15 (6.7m³/h)

PUMP MODEL	MOTOR POWER		NOMINAL PUMP SIZE in Inches (Suc x Del)	DISCHARGE IN lps / m³/h											
				0	0.6	0.8	1.1	1.4	1.7	1.9	2.2	2.5	2.8	2.5	
	0	2		3	4	5	6	7	8	9	10	11			
CTB-7/11M	1.1	1.5	1½ x 1	34	33	32	30.5	29	28	27	25	24	23	20	

CTB SERIES TWIN IMPELLER

Performance Curves

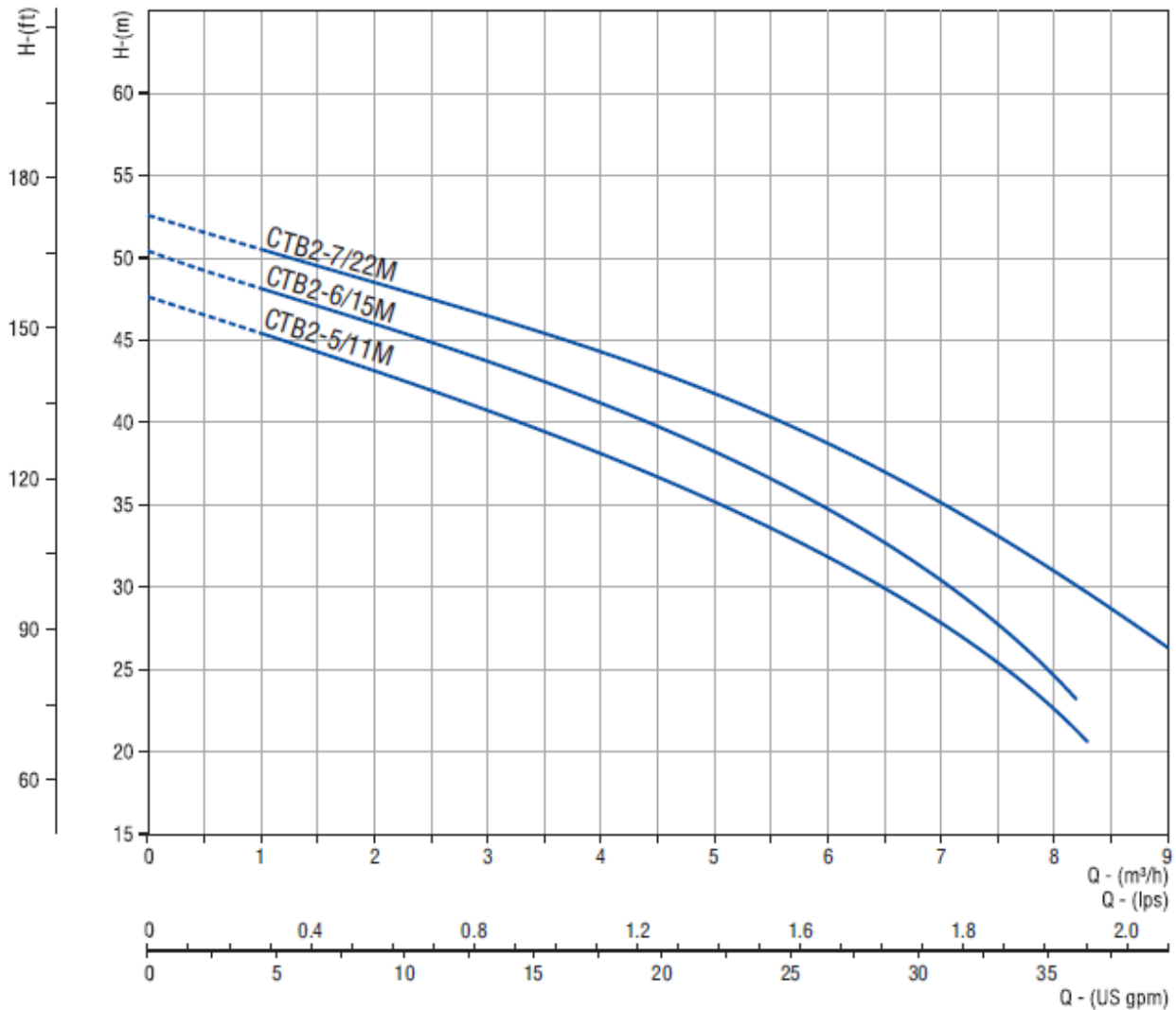

Performance Charts

PUMP MODEL	MOTOR POWER		RATED CURRENT(A)		NOMINAL PUMP SIZE in Inches (Suc x Del)	DISCHARGE IN lps / m³/h								
	kW	HP	1Ph 230V	3Ph 380V		0	0.6	0.8	1.1	1.4	1.7	1.9	2.2	2.5
						0	2	3	4	5	6	7	8	9
CTB2-5/11M	1.1	1.5	8.32	2.65	1¼ x 1	47.5	43	41	38	35.5	32	27.5	22	
CTB2-6/15M	1.5	2	10.13	4.2	1¼ x 1	50.5	47	43	41	38	35	30	25	
CTB2-7/22M	2.2	3	13.43	5.2	1¼ x 1	52.5	48.5	46	44	42	38.5	35	31	26

Dimensional Drawings

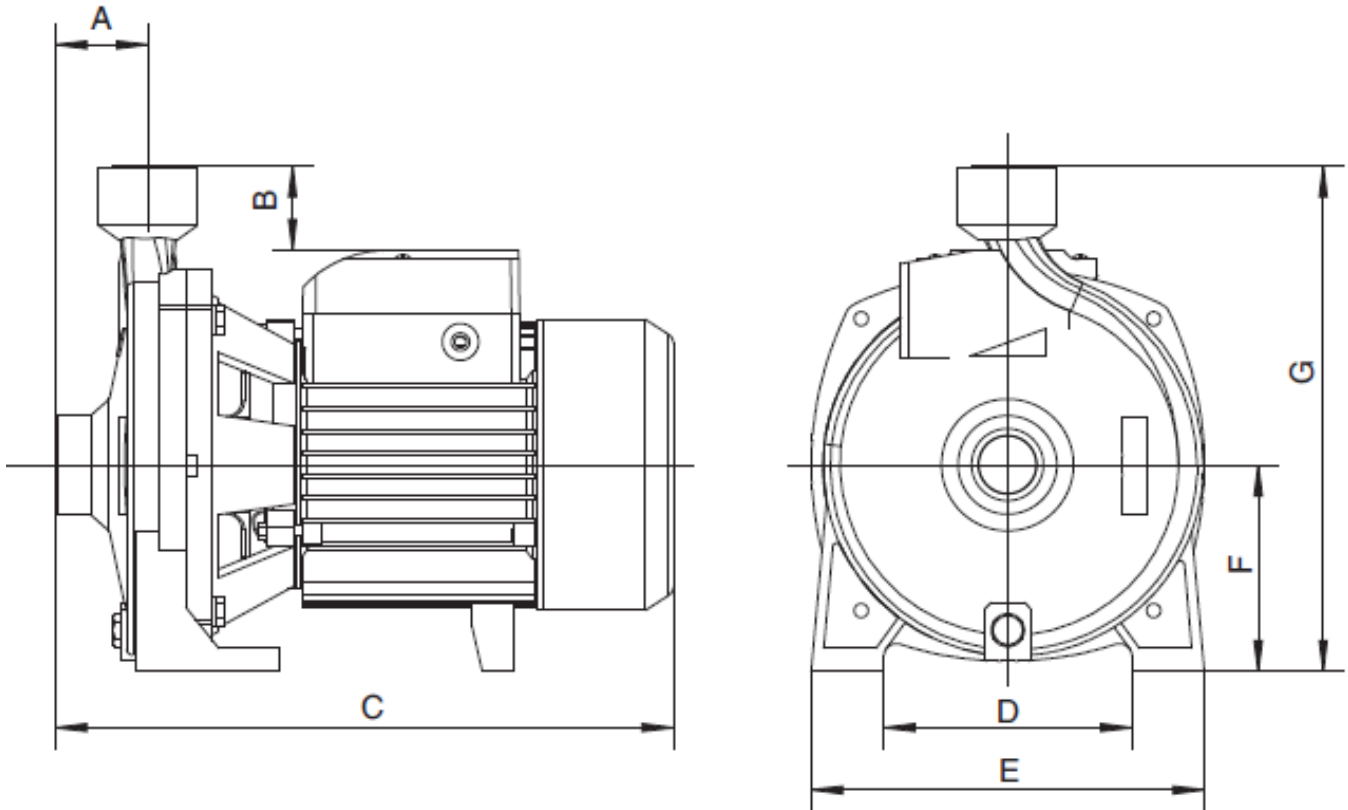

Dimensional Data

PUMP MODEL	MOTOR POWER		A	B	C	D	E	F	G	APPROX. NETT WT in kg
	kW	HP								
CTS-4/03M	0.37	0.5	46	20	285	113	150	84	207	9.5
CTS-5/05M	0.55	0.75	48	27	320	140	182	100	240	15
CTS-6/07M	0.75	1.0	48	27	320	140	182	100	240	15.5
CTB-6/11M	1.1	1.5	44	46	352	180	220	115	284	21.5
CTB-7/11M	1.1	1.5	50	25	302	140	200	105	255	19
CTB-8/15M	1.5	2.0	44	46	363	180	220	115	284	22.5
CTB-15/11M	1.1	1.5	60	20	375	160	207	112	159	22
CTB-18E/15M	1.5	2.0	57	44	385	135	182	107	218	23
CTB-35/22M	2.2	3.0	68	65	435	190	240	120	312	30
CTB2-5/11M	1.1	1.5	81	20	387	170	210	117	264	21.5
CTB2-6/15M	1.5	2.0	81	20	387	170	210	117	264	22.5
CTB2-7/22M	2.2	3.0	90	38	450	190	240	135	300	30.5



The
WATER & SOLAR COMPANY
WATER & ENERGY SYSTEMS



+27 62 375 5088



+27 65 321 5803



<https://www.thewatersolarcompany.co.za/>



<https://maps.app.goo.gl/MBR2LMW3T6f9TtHV9>



<https://www.facebook.com/watersolarcompany>



<https://www.youtube.com/@TheWaterSolarCompany/>



<https://www.instagram.com/watersolarcompany2023/>